

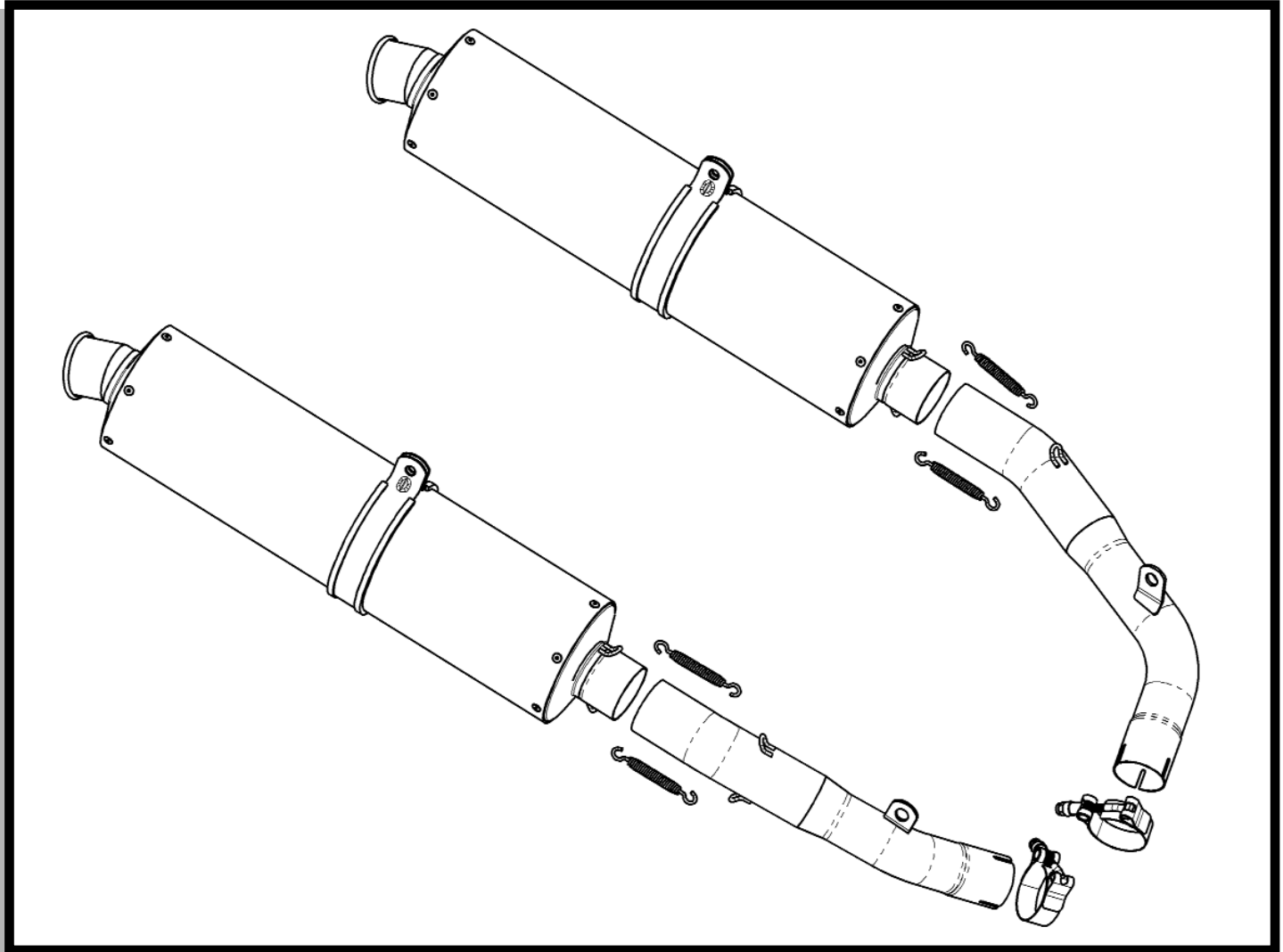

SLIP-ON RT1 EXHAUST SYSTEM

HONDA RC51 2002-06
18-1015-__3-02 RACE
18-1015-__2-02 STREET



PARTS INCLUDED

- 1 - Slip-on S-bend, Left
- 1 - Slip-on S-bend, Right
- 2 - Mufflers, Left & Right
- 2 - T-Bolt Clamps
- 4 - Swivel Springs
- 2 - Muffler Clamps
- 2 - Rubber Strips

TOOLS REQUIRED

- Ratchet
- Sockets
- Wrenches

SLIP-ON RT1 EXHAUST SYSTEM

HONDA RC51 2002-06
18-1015-__3-02 RACE
18-1015-__2-02 STREET

INSTALLATION INSTRUCTIONS

- 1) Make sure the motorcycle is placed securely on a service lift or stand, and that the exhaust system is cool.
- 2) Loosen pinch bolts on the left and right stock s-bends. Remove and retain the s-bend mounting bolts from the mounting tabs on the left and right s-bends.
- 3) Remove and retain the left and right canister mounting bolts. Remove the left and right muffler assemblies.
- 4) Place one provided t-bolt clamp onto the left Jardine s-bend inlet and slide it onto the left headpipe outlet. Do not fully tighten at this time. **NOTE:** Make sure that the t-bolt clamp is positioned so that you can tighten it when installed on the motorcycle.
- 5) Install the left Jardine muffler onto the left s-bend.
- 6) Attach the supplied rubber strip to the inside of one muffler clamp. Slide the muffler clamp over the muffler and squeeze both muffler clamp tabs together. Secure the muffler clamp to the passenger peg mount using the original hardware. Do not fully tighten yet.
- 7) Using the original bolt, loosely attach the left s-bend mounting bracket to the original location on the left rider peg mount.
- 8) Install two supplied springs to the s-bend/muffler connection. Align the muffler and fully tighten the t-bolt clamp, s-bend mounting bolt, and muffler mounting bolt.
- 9) Repeat steps 3-6 for the right side.
- 10) Start the motorcycle and check for any exhaust leaks.