

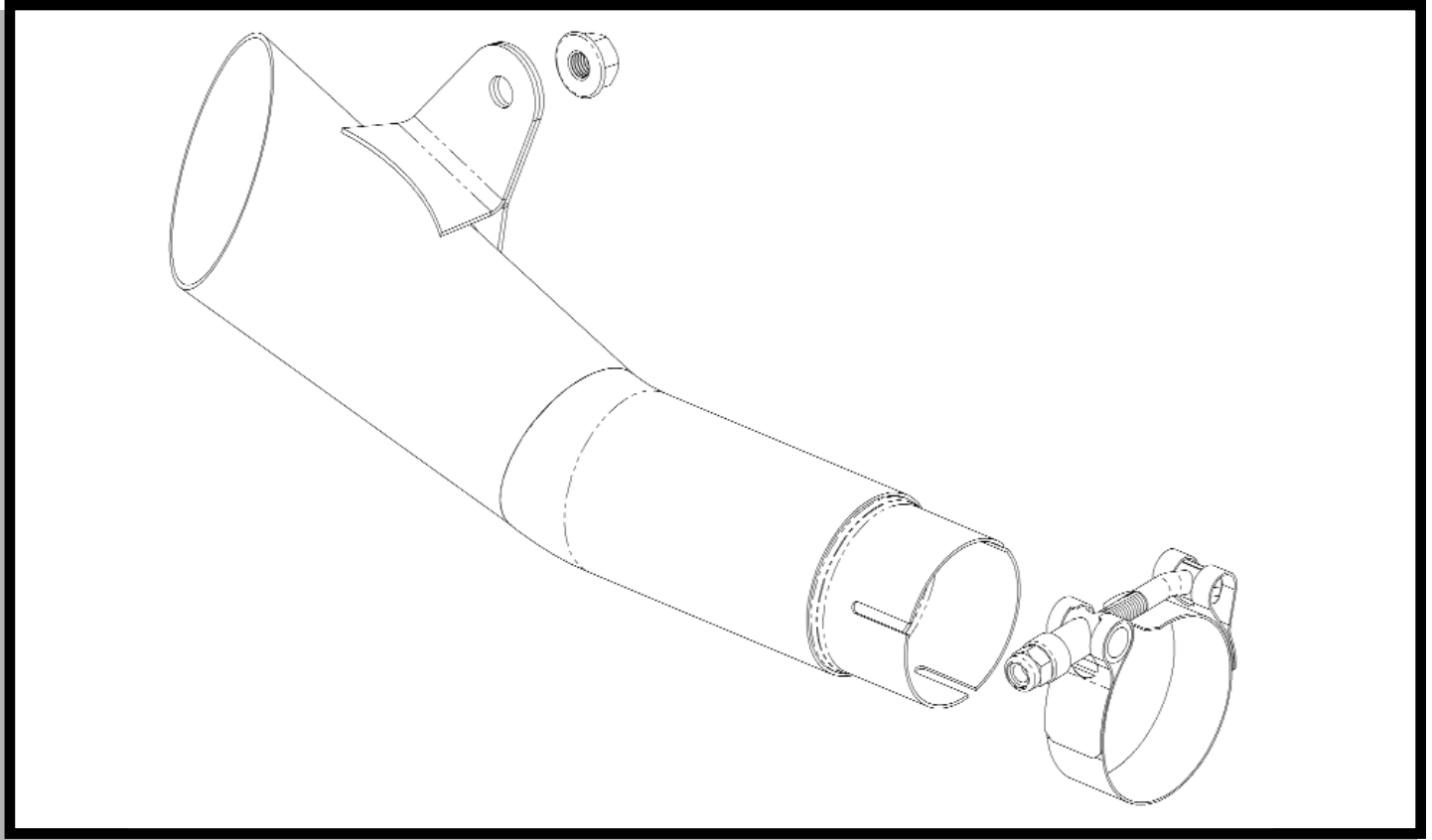

18-2009-723-02

GP1 SLIP-ON EXHAUST SYSTEM

YAMAHA YZF-R6
2006



PARTS INCLUDED

- 1 - GP1 Slip-on Exhaust
- 1 - T-Bolt Clamp
- 1 - M8-1.25 Hex Flange Nut

TOOLS REQUIRED

- Ratchet
- Sockets
- Wrenches

18-2009-723-02

GP1 SLIP-ON EXHAUST SYSTEM

YAMAHA YZF-R6
2006

INSTALLATION INSTRUCTIONS

- 1) Make sure the motorcycle is cool and place securely on a service lift or center stand.
- 2) Remove the right side lower fairing from the motorcycle.
- 3) Remove the three bolts securing the front muffler cover, exposing the exhaust valve. Disconnect the cables from the exhaust valve.
- 4) Remove the bolt securing the cable guide bracket to the footpeg mount. See Figure #1
- 5) Remove and retain the muffler mounting bolt. Remove the muffler inlet clamp bolt. Remove the OEM muffler from the motorcycle. Make sure the gasket & retaining ring are removed as well.
- 6) Remove the rear brake reservoir bolt. Remove the two bolts that secure the exhaust valve servo to the frame. These are located near the rear shock.
- 7) Remove the servo by pulling it out to the right of the frame. Unplug the servo wiring. Remove the two cables from the servo pulley. Reconnect the servo wiring and reinstall it in place using the original hardware. See Figure #2.
NOTE: The servo must be installed and plugged in or the motorcycle computer will display an error code and run in safe mode.
- 8) Reinstall the brake reservoir.
- 9) Slide the supplied t-bolt clamp over the new GP1 exhaust pipe inlet. Be sure to position the bolt so that it can be tightened when installed on the motorcycle. Slide the GP1 pipe onto the header outlet. Do not tighten clamp at this time. See Figure #3.

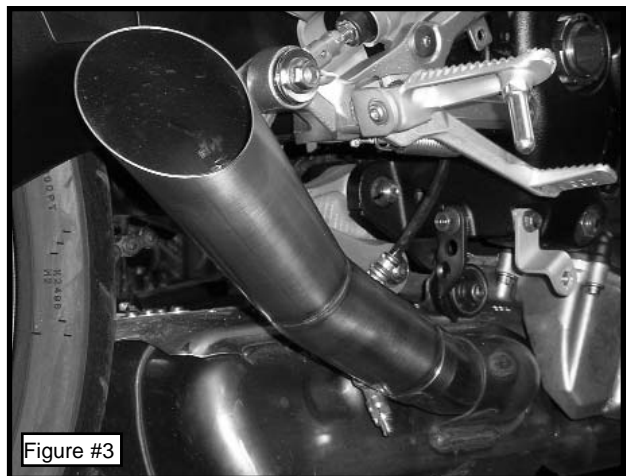
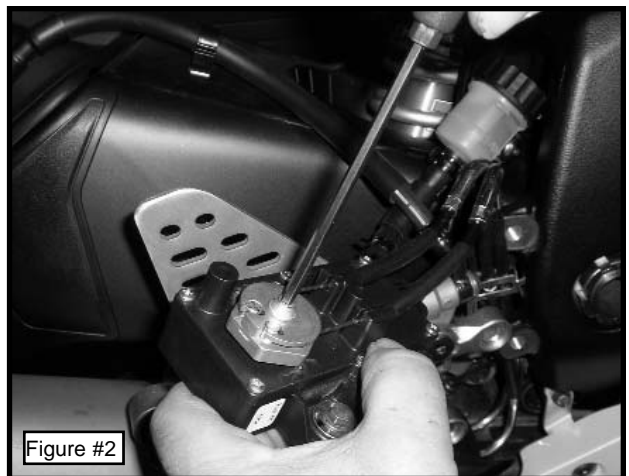
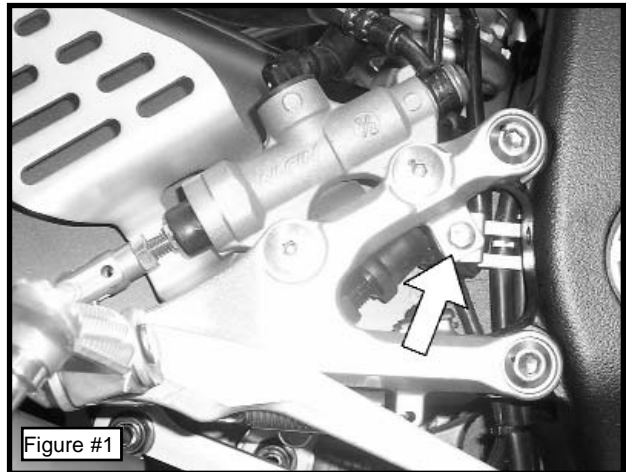

18-2009-723-02

GP1 SLIP-ON EXHAUST SYSTEM

YAMAHA YZF-R6
2006

INSTALLATION INSTRUCTIONS

- 10) Place the GP1 mounting bracket behind the footpeg mount and secure using the original muffler mounting bolt and the supplied M8-1.25 hex flange nut. See Figure #3.
- 11) Position the exhaust pipe and then fully tighten the t-bolt clamp, then the mounting bracket bolt.
- 12) Start the motorcycle and check for any exhaust leaks.
- 13) Reinstall the lower right side fairing.