

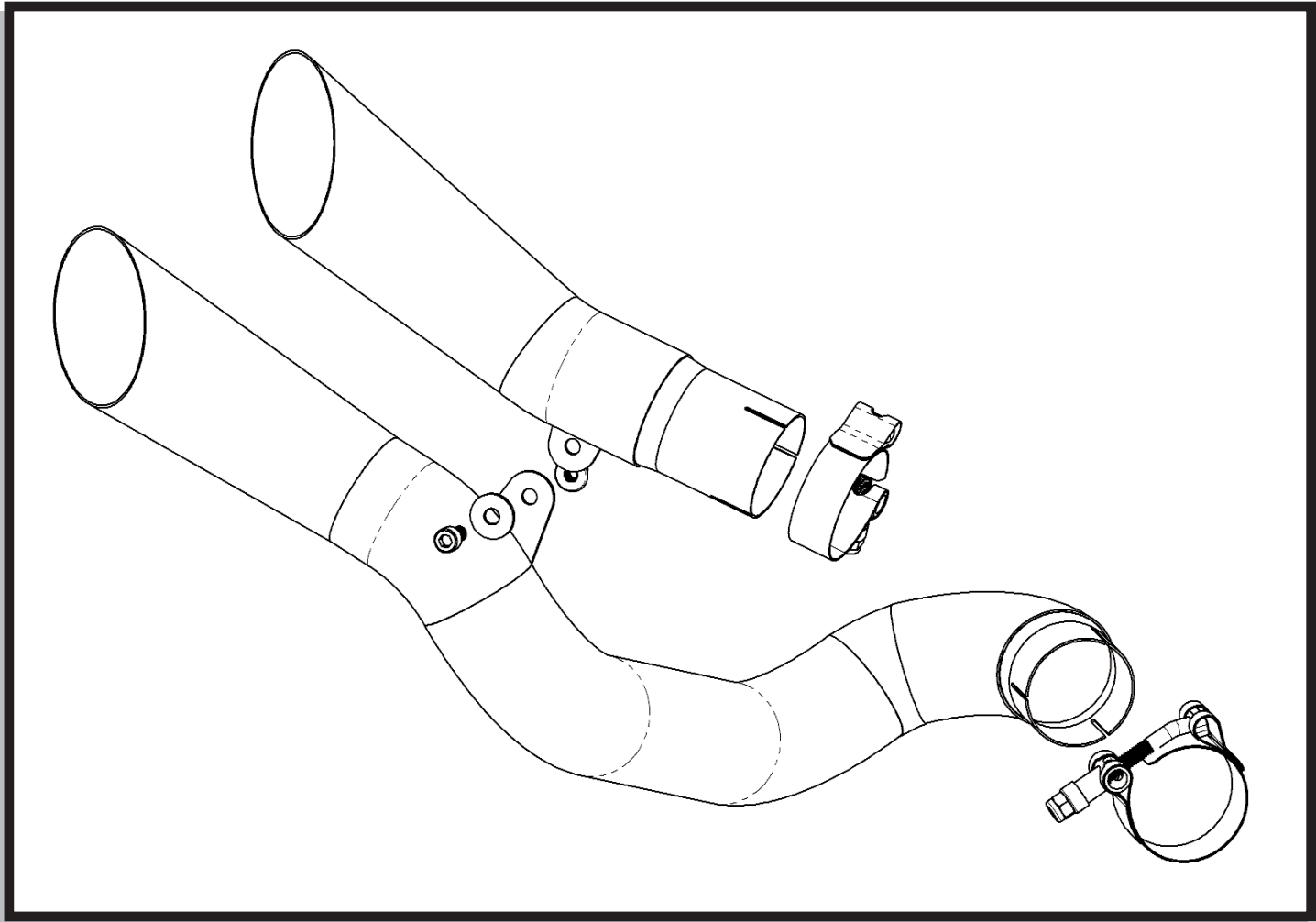

18-4018-723-02

GP1 DUAL SLIP-ON EXHAUST

SUZUKI GSX-R1000
2007



PARTS INCLUDED

Ref.	Part Number	Description	Qty
1)	00-200-00013	Left/Bottom Slip-on GP1 Exhaust Pipe Assembly	1
2)	00-200-00014	Right/Top Slip-on GP1 Exhaust Pipe Assembly	1
3)	07-3842058-35	T-Bolt Clamp	2
4)	01-5406100012-SS	Socket Head Cap Screw, M6-1.0x12mm, S/S	1
5)	01-7406100-27	Hex Flange Nut, M6-1.0	1
6)	01-7806-27	Flat Washer, 6mm	1
7)	04-18-42112	Quiet Module Insert	2
8)	01-5106100012-SS	Socket Button Head Cap Screw, M6-1.0x12mm, S/S	2
9)	01-8606-27	Star Lock Washer, 6mm	2

REV. A
08-50-43001

18-4018-723-02

GP1 DUAL SLIP-ON EXHAUST

SUZUKI GSX-R1000
2007

TOOLS REQUIRED

Ref.	Description	Ref.	Description
1)	3/8" Drive Ratchet	6)	10mm Socket
2)	3" Extension	7)	11mm Socket
3)	4mm Allen Socket	8)	12mm Socket
4)	5mm Allen Socket	9)	Drill Motor (optional)
5)	12mm Wrench	10)	1/4" Drill Bit (optional)

INSTALLATION INSTRUCTIONS

1) Make sure the motorcycle is cool and place securely on a service lift or center stand.

2) Remove the two bolts securing the plastic exhaust pipe guard below the right side rider footpeg. Remove the guard from the motorcycle. See Figure #1

3) Loosen the clamp bolt securing the stock left side midpipe to the catalytic box under the motor. See Figure #2

4) Remove the bolt securing the stock left side muffler to the passenger peg mount. See Figure #3

5) Remove the complete left side muffler assembly from the motorcycle. If the stock gasket was not removed with the muffler assembly, remove it from the catalytic outlet now.

6) Loosen the clamp bolt securing the stock right side midpipe to the catalytic box under the motor.

7) Remove the bolt securing the stock right side muffler to the passenger peg mount.

8) Remove the complete right side muffler assembly from the motorcycle. If the stock gasket was not removed with the muffler assembly, remove it from the catalytic outlet now.

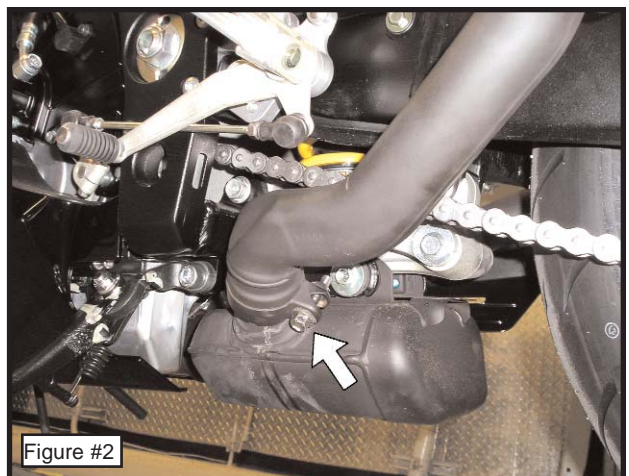

18-4018-723-02

GP1 DUAL SLIP-ON EXHAUST

SUZUKI GSX-R1000
2007

- 9) Place one supplied t-bolt clamp onto the inlet of the left side GP1 slip-on pipe. Position the GP1 pipe under the swingarm and slide it onto the left side catalytic outlet. Do not tighten the clamp at this time.
- 10) Place the remaining t-bolt clamp onto the inlet of the right side GP1 slip-on pipe. Slide the GP1 pipe onto the right side catalytic outlet. Do not tighten the clamp at this time.

NOTE: When both pipes are installed, the left/bottom GP1 mounting bracket should be positioned outside of the right/top GP1 mounting bracket.

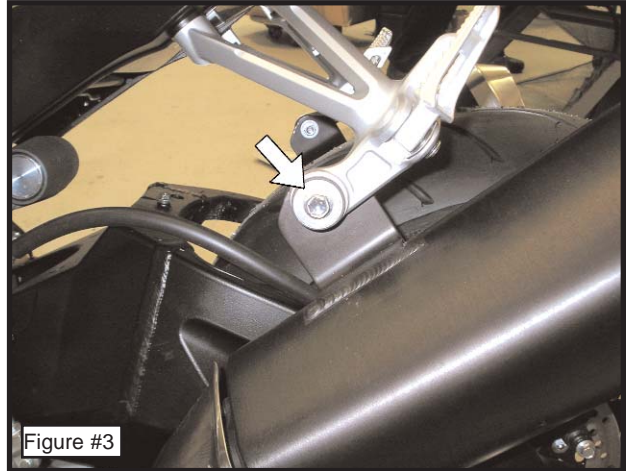

- 11) Using the supplied M6-1.0x12mm socket head bolt, 6mm flat washer, and M6-1.0 hex flange nut. Secure the right/top and left/bottom GP1 pipes together. Do not fully tighten at this time.
- 12) Position the two GP1 exhaust pipes, then fully tighten the left & right t-bolt clamps. Fully tighten the mounting bracket hardware.
- 13) Clean all fingerprints and grease from the GP1 pipes.
- 14) Start the motorcycle and check for any exhaust leaks.

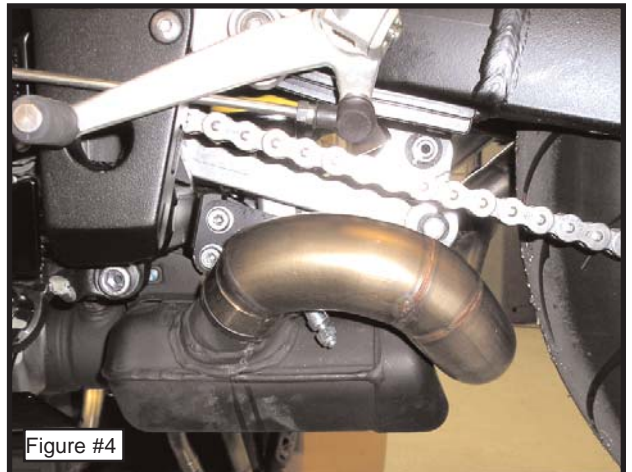

OPTIONAL QUIET MODULE INSERT (QMI)

THE FOLLOWING IS AN OPTIONAL INSTALLATION ONLY. THE QMI IS INSTALLED WHEN THE REGULAR SOUND OUTPUT OF THE GP1 EXHAUST IS TOO LOUD FOR THE RIDER.

- 1) Follow the above instructions in order to remove the Jardine GP1 exhaust from the motorcycle.



18-4018-723-02

GP1 DUAL SLIP-ON EXHAUST

SUZUKI GSX-R1000
2007

- 2) Carefully place the exhaust system on a workbench or table.

NOTE: A hole must be drilled in the back side of both GP1 megaphone sections. All of the following steps pertain to both GP1 pipes.

- 3) Measure 3" from the tip of the megaphone section of the exhaust, and make a mark. See Figure #6.
- 4) Carefully drill a 1/4" hole in the megaphone where you made your mark.
- 5) Slide the QMI insert inside the megaphone and position it so that the threaded hole in the QMI is showing through the new drilled hole. Secure the QMI to the megaphone using the supplied M6-1.00x12mm button head bolt and locking star washer.
- 6) Perform steps 3-5 for the second GP1 pipe.
- 7) Reinstall the exhaust system to the motorcycle.

